



SEPTEMBER 2025

Repair Work to: The Poultry Cross

Salisbury City Council

Presentation to the City Council

| Date | Revision | By | Checked |
|----------|-------------|----|---------|
| 12.09.25 | First Issue | LS | JS |

Site Location

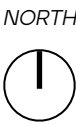

A Brief History

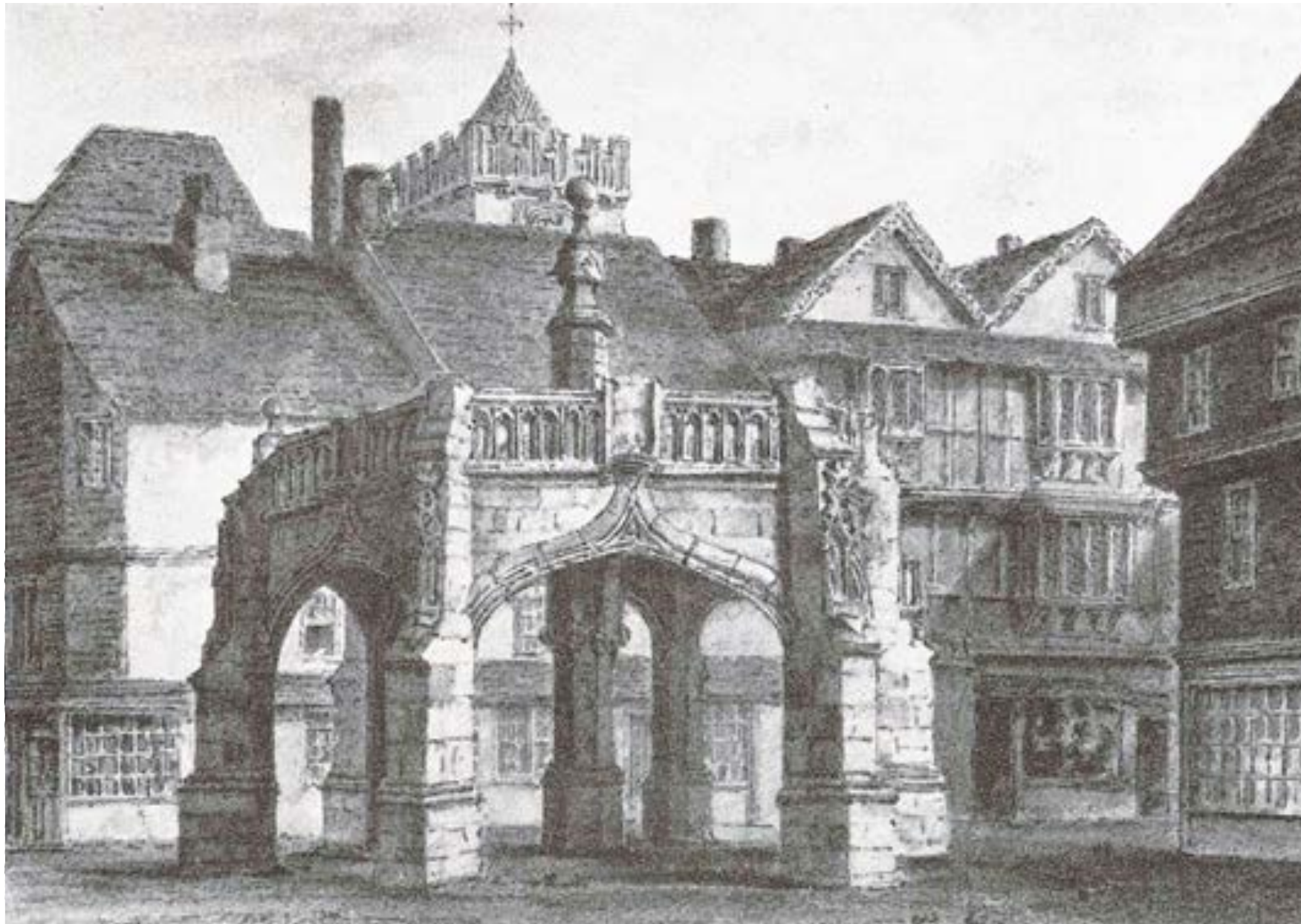

1810 Watercolour (J. Buckler) ahead of 1850's alterations

- ★ The Poultry Cross is the only one remaining of four market crosses that once stood in Salisbury.
- ★ In 2025 the Poultry Cross was added to Historic England's 'Heritage At Risk Register'
- ★ The Poultry Cross is both a Grade I Listed building and a Scheduled Ancient Monument, meaning it is of exceptional interest and national importance. It is a significant local landmark and integral to the fabric of the historic city.

Victorian Alterations

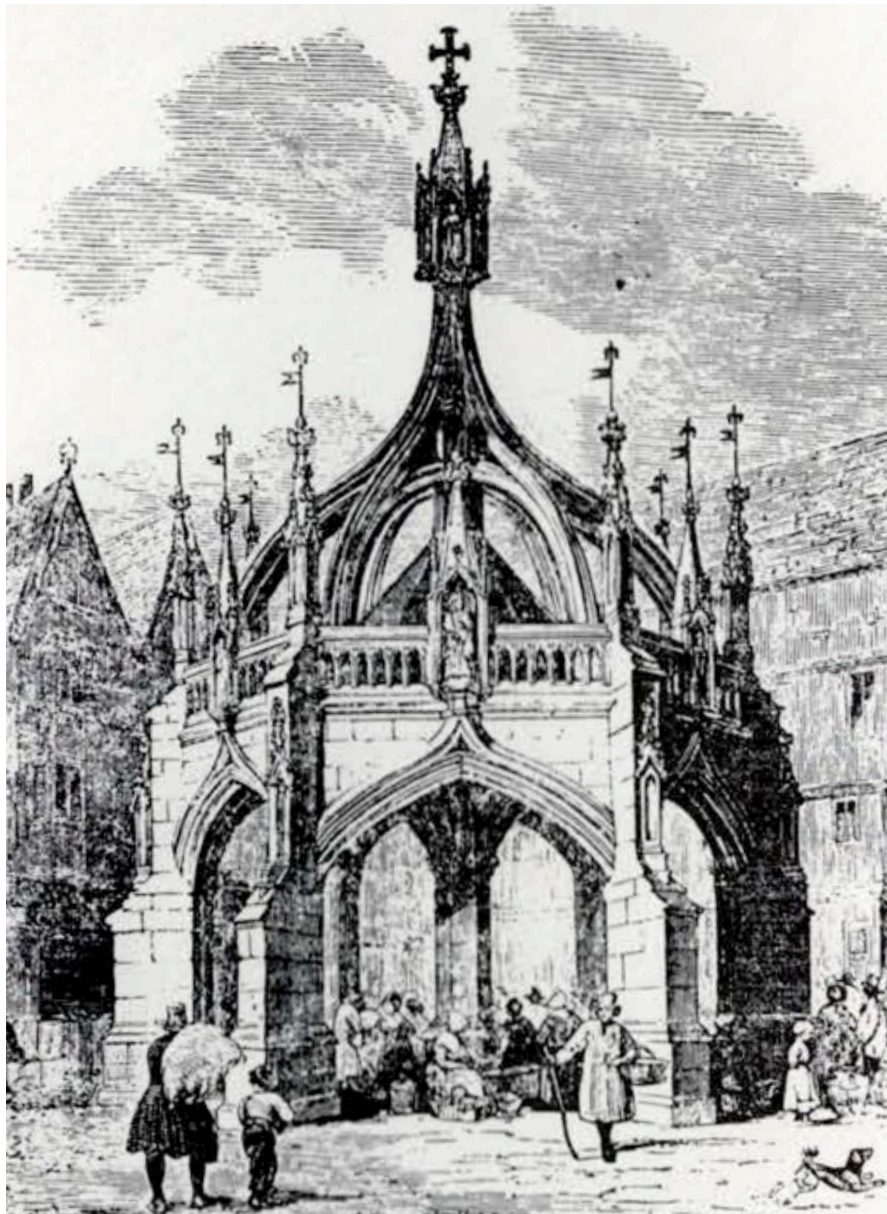

Circa 1890



- ★ Images of the Poultry Cross after the alterations of 1850 clearly showing weathervanes mounted on top of the pinnacles.

The Poultry Cross Today



- ★ Roof finishes in a poor condition
- ★ Water ingress evident
- ★ Poorly detailed, with cracking to the lead sheet

Roof Assessment

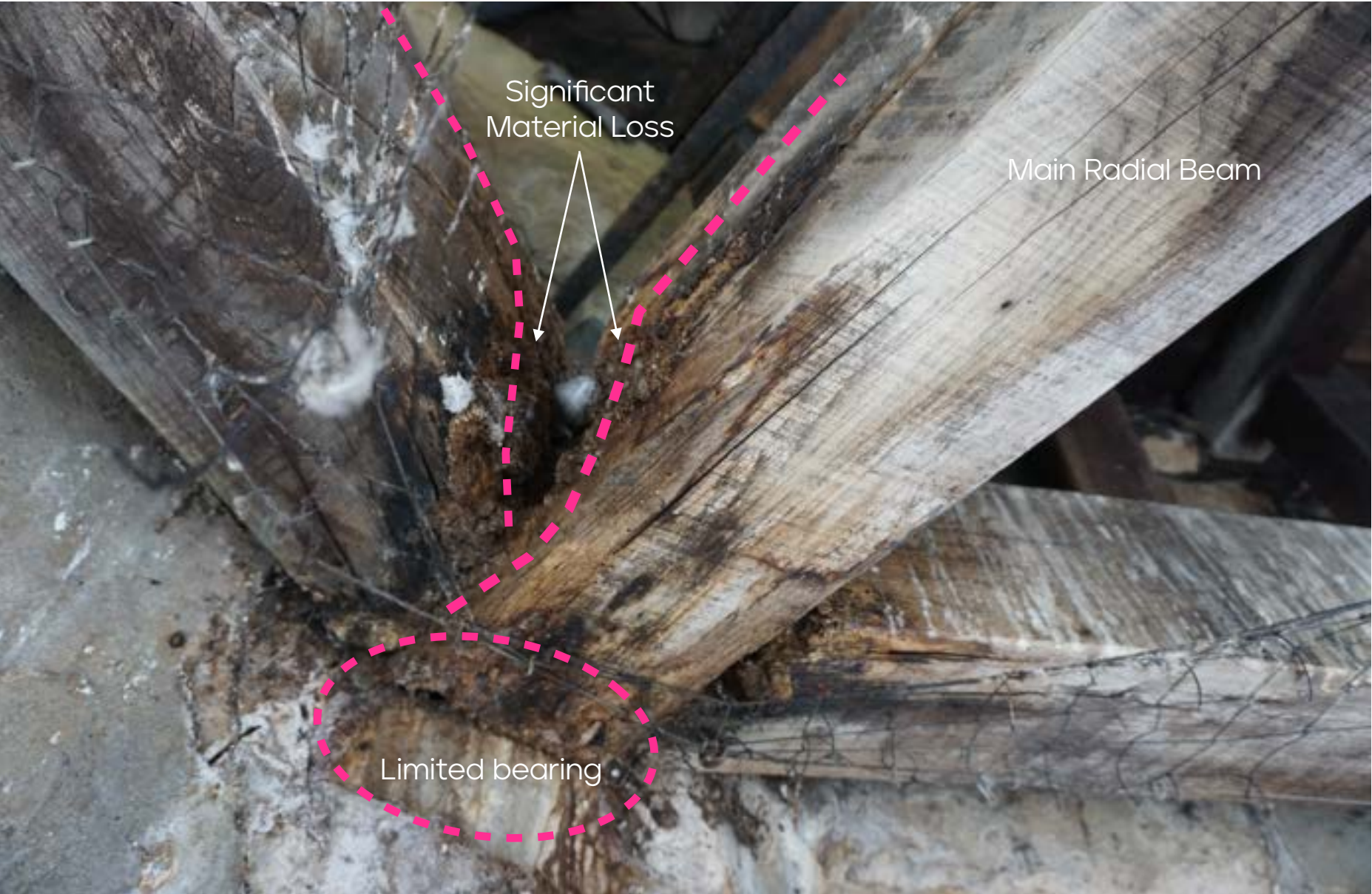

Significant timber decay to primary roof structure



Water ingress to majority timber and boards

Roof Repair Priority

- ★ It is critical to prioritise roof repairs ahead of other conservation work to ensure that the roof is watertight.
- ★ Internally, the exposed roof timbers are water-streaked and decayed, notably at bearing ends.
- ★ Repairing the lead roof structure is therefore the highest priority item, as persistent water ingress will continue to cause further timber decay of the roof structure.

Loop Architects scheduling drawing

- Red = Significant Timber Decay
- Orange = Decay to structural timbers
- Green = Signs of water damage

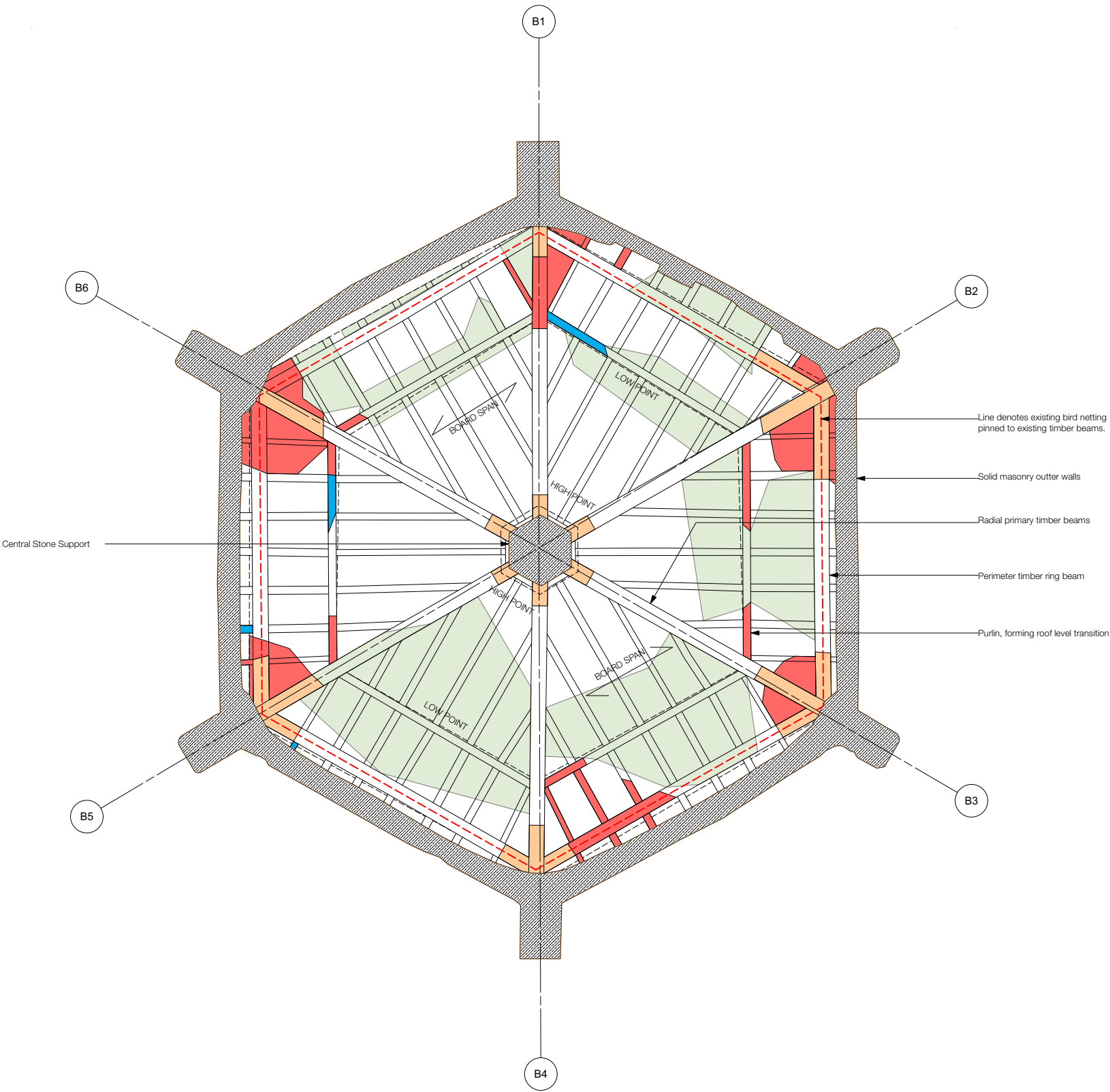

Phased Repair

TRUE ELEVATIONS - SECTIONS

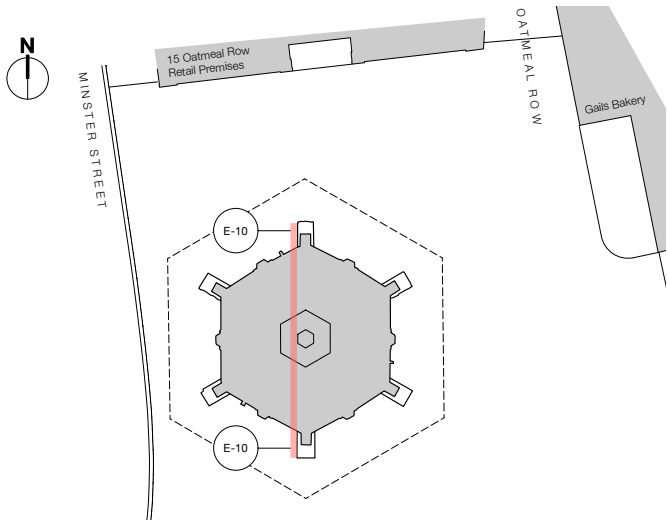
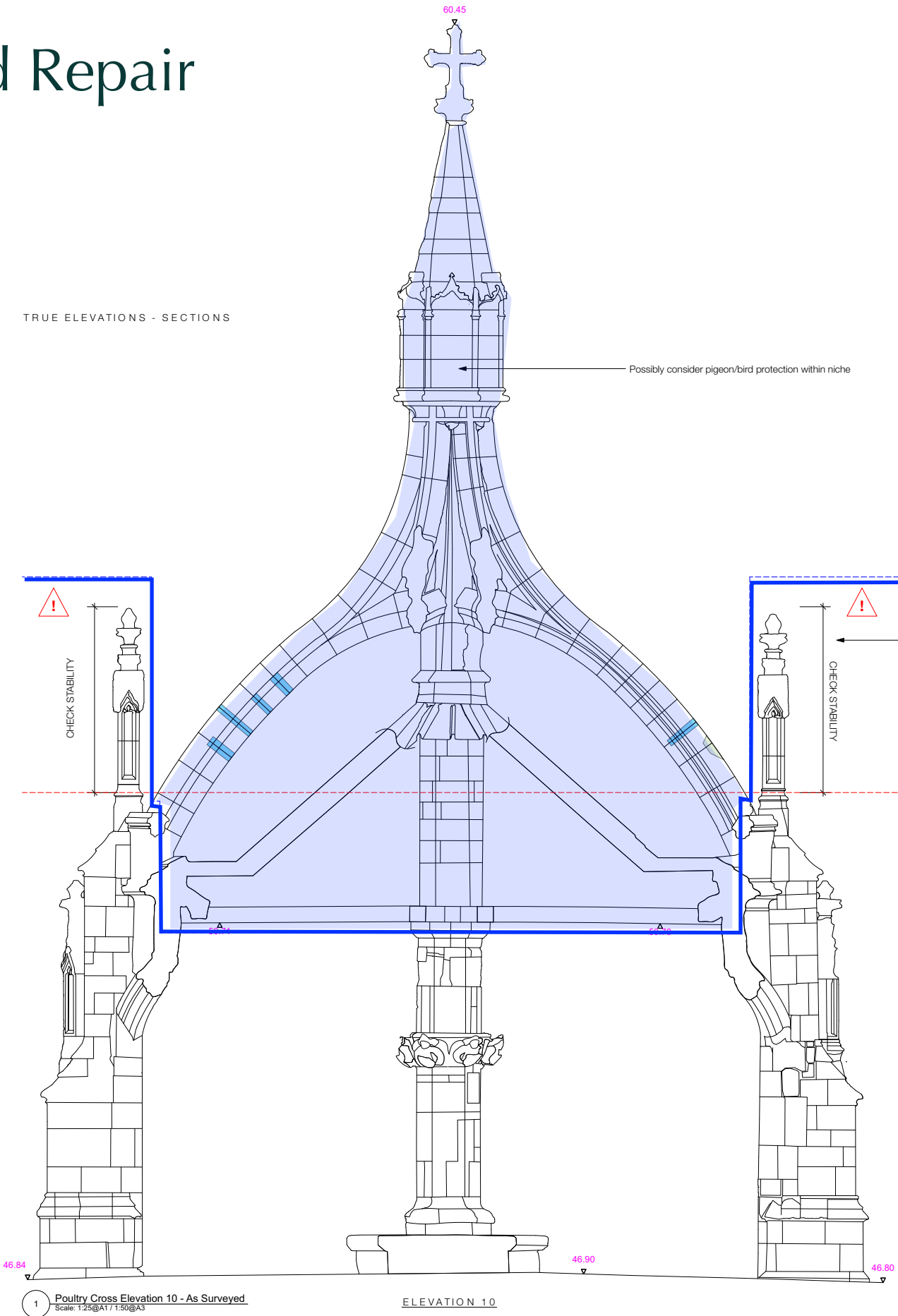

KEY:

- Masonry Replacement
- Mortar Repair
- Repointing
- Pin
- Denotes removal/demolition.

Notes:

- Significant Timber Decay
- Significant Timber Water Damage (Damp)
- Timber Splitting and Defects
- Significant Decay to Primary Structure (Ring/Radial Beams)
- Denotes existing Lead sheet roof finish
- Denotes existing asphalt/bitumen membrane
- Denotes Buttress Number

A Text here text here
B Text here text here

Note:
For detailed structural review please refer also to the Structural Engineers survey, plans & report

Notes on Elevation numbering:
Please refer to site plan for elevation numbering.
Based on surveyed information from Mecon Surveys Ltd.

PHASE 1 - INDICATIVE LINE

- ROOF COVERINGS & STRUCTURAL REPAIRS
- VICTORIAN MASONRY - 'CROWN'
- REAR OF PARAPET/ROOF JUNCTION ABUTMENT
- STONEMWORK WITHIN ROOF AREA

Phase 1

- ★ Roof coverings & structural repairs
- ★ Victorian masonry 'Crown'
- ★ Rear of parapet/roof junction abutment
- ★ Stonework within the roof area

1 Poultry Cross Elevation 10 - As Surveyed
Scale: 1:25@A1 1:50@A3

ELEVATION 10

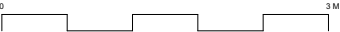

| ISSUED FOR INFORMATION | | | | AS | LS |
|---|------|-------|-------------------------------------|---------|---------|
| REV | DATE | NOTES | DESIGN | DRAWN | CHECKED |
| Loop Architects Ltd | | | | | |
| 40 Bourne Avenue, Salisbury, SP1 1LS T: 01722 273 194 E: hello@looparchitects.co.uk | | | | | |
| Poultry Cross Repair PHASE 1 | | | July 2025 | 1:50@A3 | |
| Salisbury City Council | | | Section Elevation 10 AS SURVEYED | | |
| INFORMATION | | | 2519-10-038 | | |

Timeline

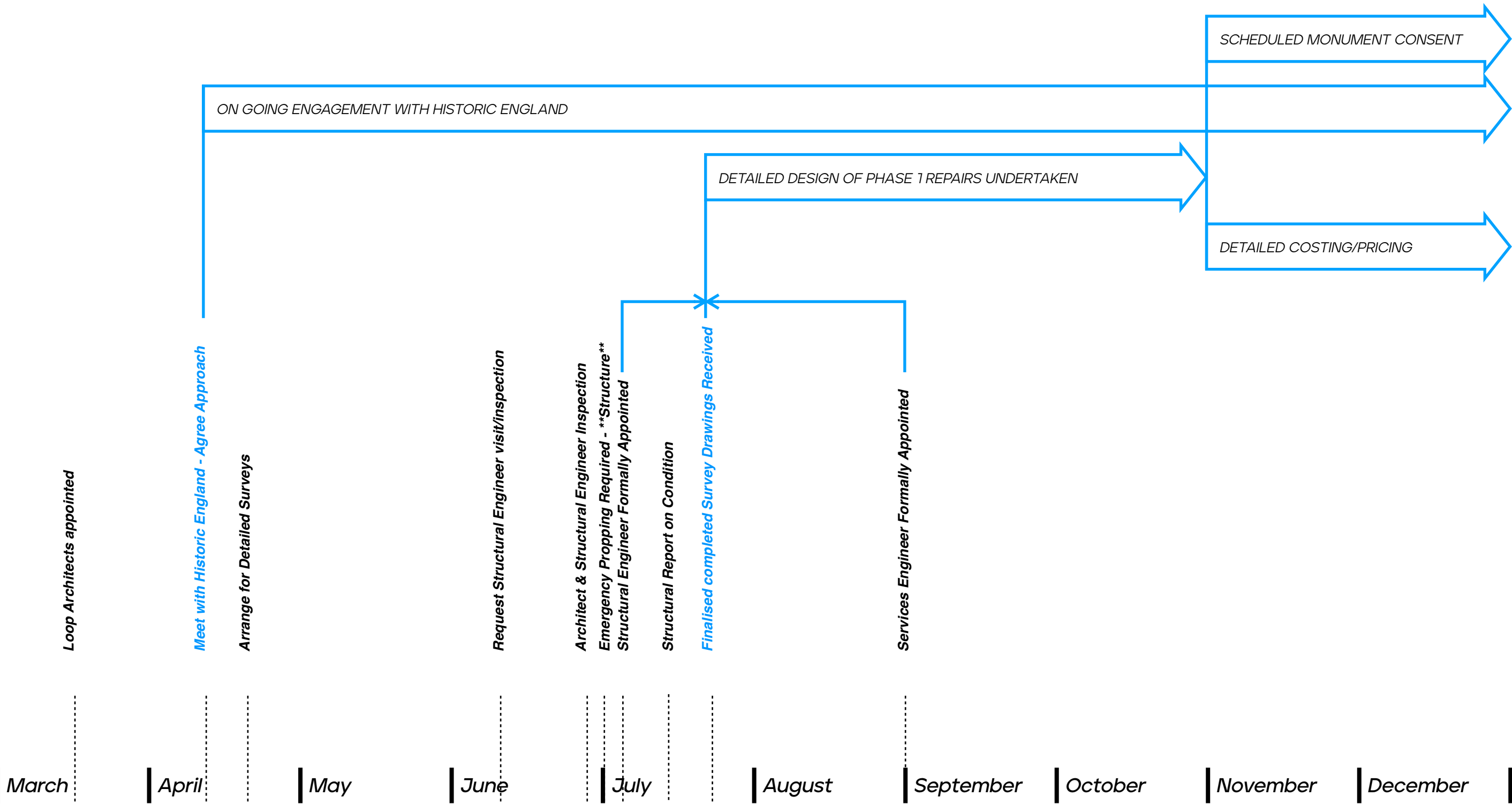

Detailed Survey



Survey being carried out in April



Data to assess condition and consider repair

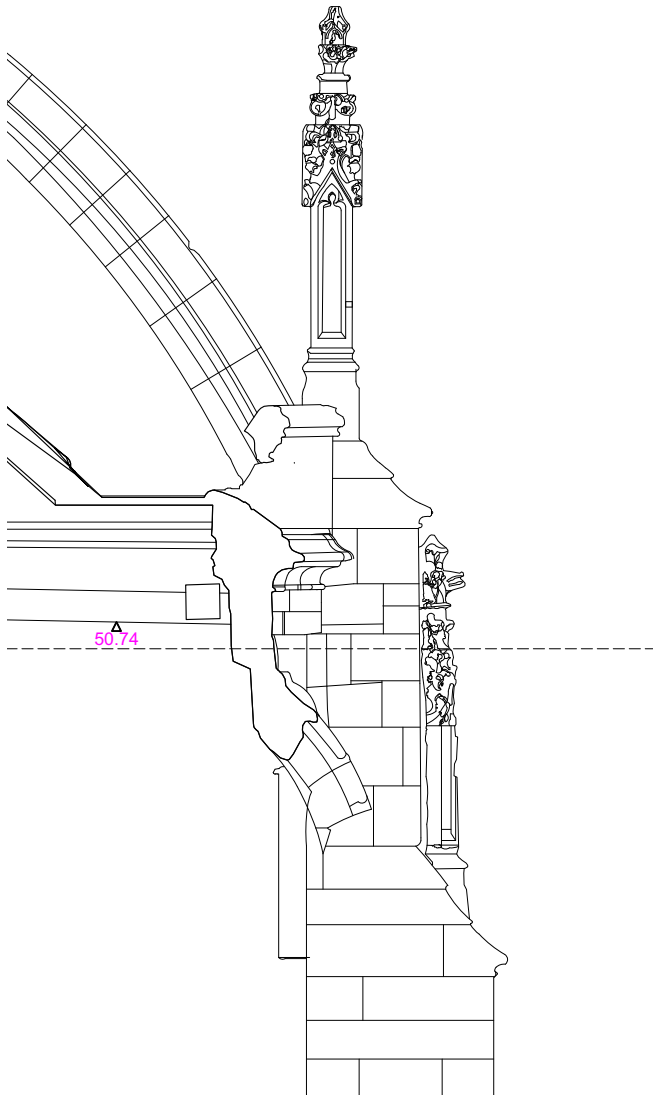

Opportunities

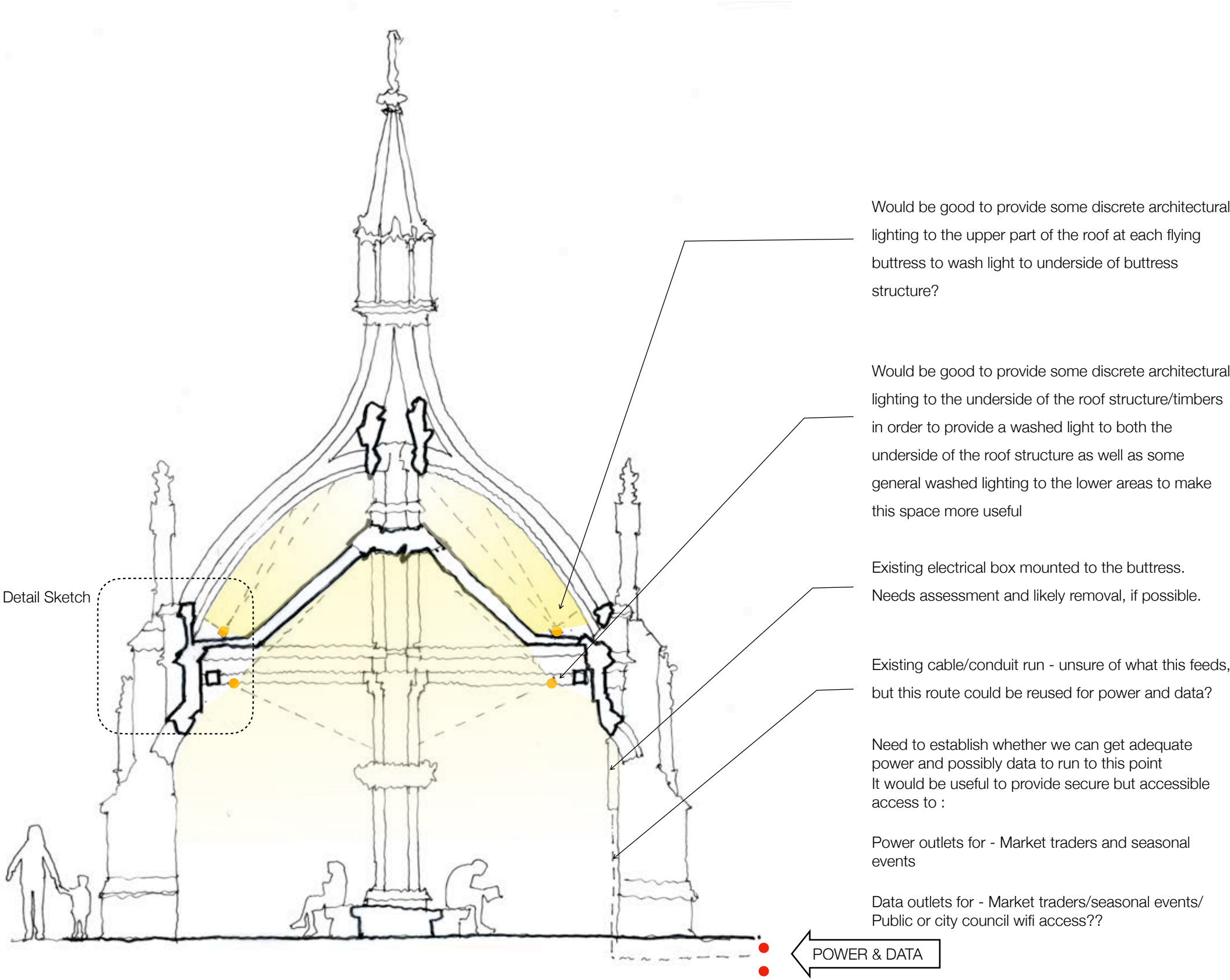

Opportunities

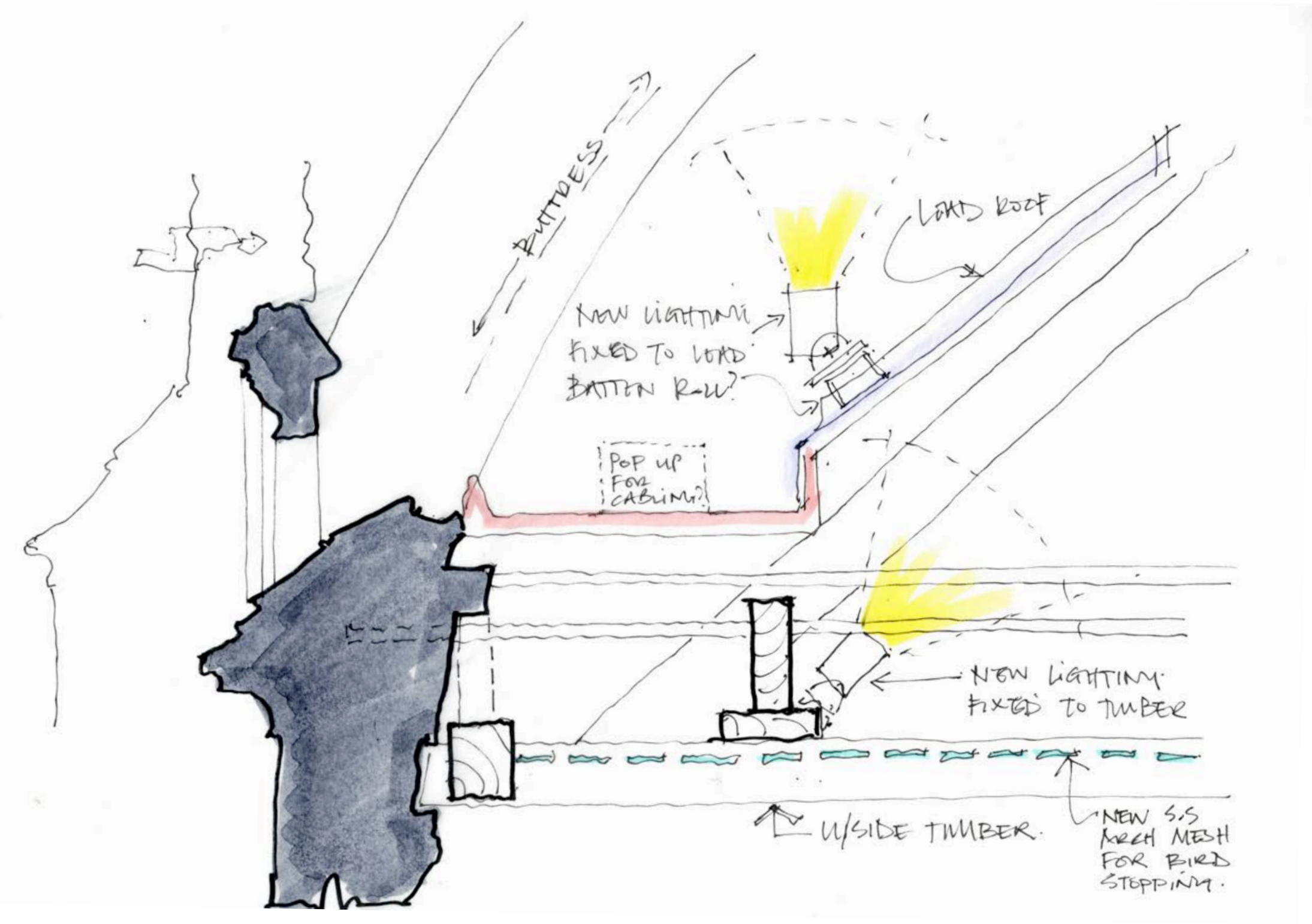

Possible Lighting



Delta Light 'Kix' External Light

Detailed Design

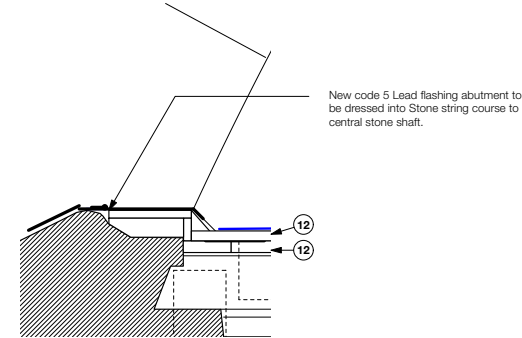
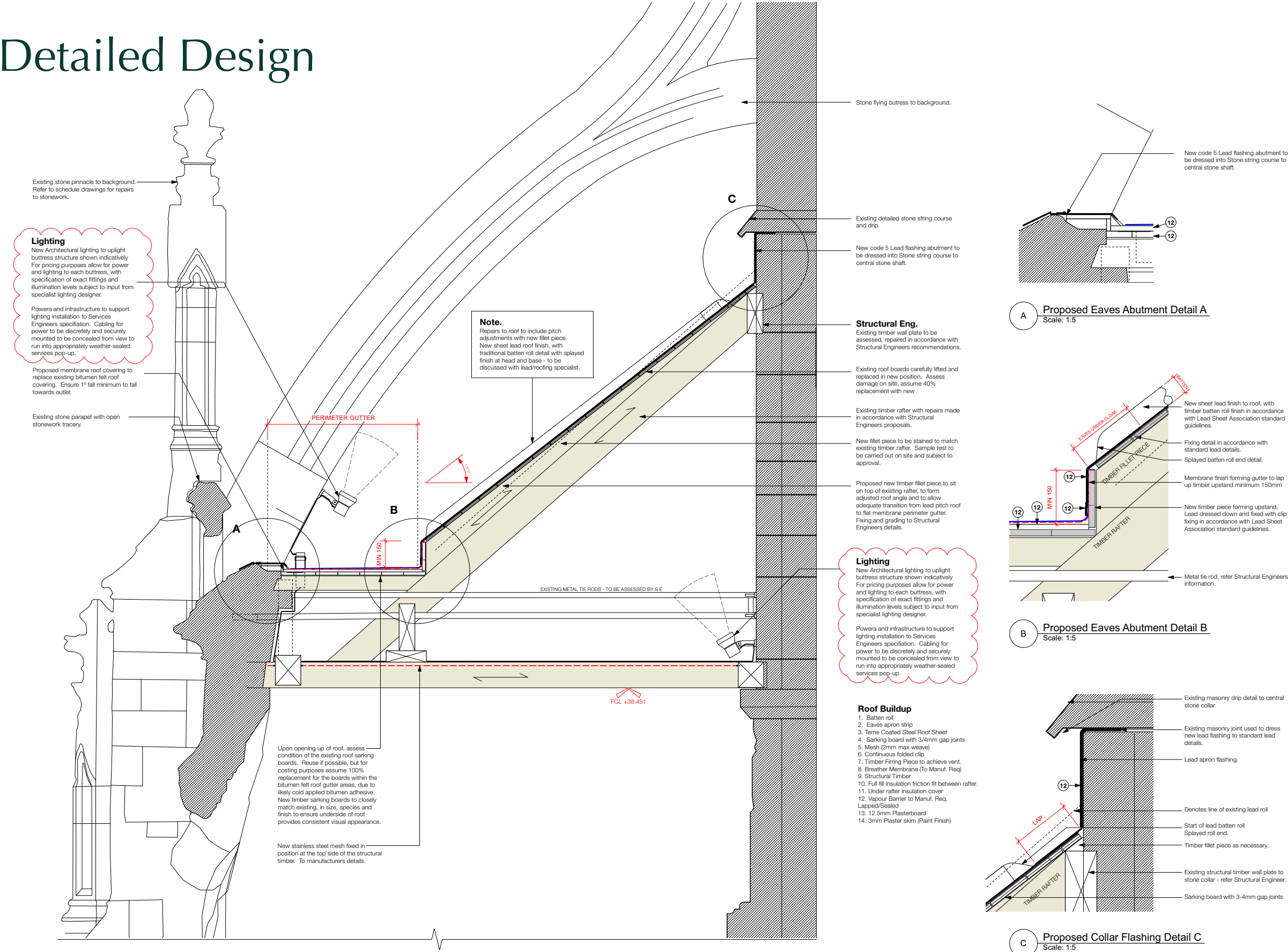

A Proposed Eaves Abutment Detail A
Scale: 1:5

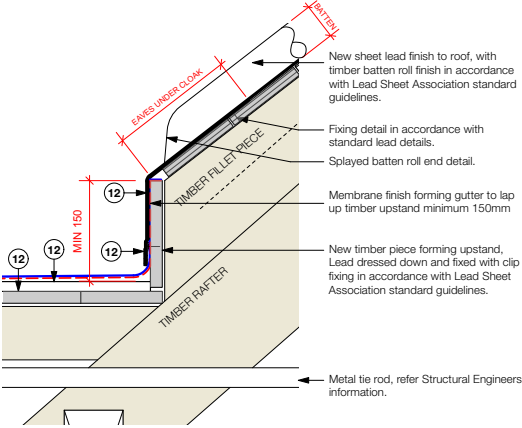

B Proposed Eaves Abutment Detail B
Scale: 1:5

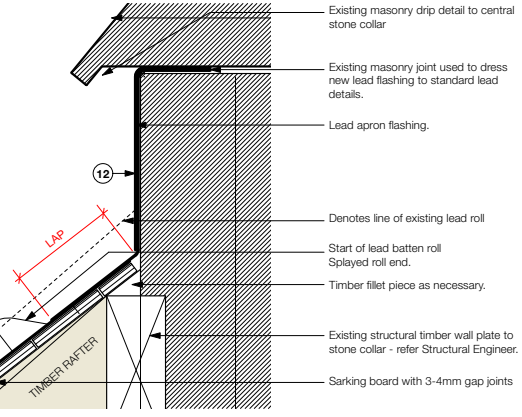

C Proposed Collar Flashing Detail C
Scale: 1:5

18/04/2025 Issued for Comment

Loop Architects Ltd

40 Bourne Avenue, Salisbury, SP1 1LS
T: 01752 279 184
E: hello@looparchitects.co.uk

Poultry Cross Repair Phase 1 - April 2025 1:258A1

Salisbury City Council Existing Elevation 5-6
- As Surveyed

DRAFT 2519-10-035

